

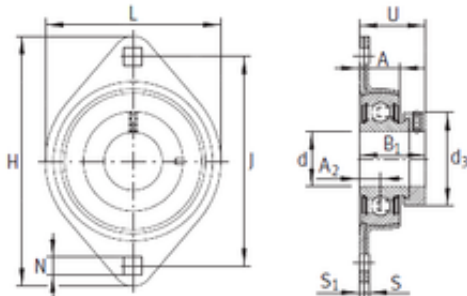

Timken BEARINGS INDUSTRY

INA PCSLT20 bearing units



PCSLT20 Bearing 2D drawings and 3D CAD models

Bearing No. PCSLT20

Bore Diameter	20 mm
d	20 mm
S1	3 mm
U	26,1 mm
d3	30 mm
A	14 mm
B1	24,6 mm
H	90,5 mm
J	71,4 mm
L	66 mm
N	8,7 mm
S	2 mm
A2	7,5 mm
Category	Flange Block Bearings
Inventory	0.0
Manufacturer Name	SCHAEFFLER GROUP
Minimum Buy Quantity	N/A
Weight / Kilogram	0.22
EAN	4012802820119
Product Group	M06110
Number of Mounting Holes	2
Mounting Method	Eccentric Collar
Housing Style	2 Bolt Flange Block
Rolling Element	Ball Bearing
Housing Material	Stamped Steel
Expansion / Non-expansion	Non-expansion



Timken BEARINGS INDUSTRY

Mounting Bolts	8.7 Millimeter
Relubricatable	No
Insert Part Number	RALE20NPPB
Seals	Double Lip Contact
Housing Configuration	2 Piece Split
Pilot Configuration	No Pilot
Inch - Metric	Metric
Long Description	2 Bolt Flange Block; 20MM Bore; 71MM Bolt Circle; 71.4MM Bolt Spacing; 2 Piece Split; Eccentric Collar Mount; Stamped Steel; Ball Bearing; 24.6MM Length Thru Bore; No Relubricatable; Double Lip Contac
Other Features	Single Row With Set Screw
Category	Flange Block
UNSPSC	31171501
Harmonized Tariff Code	8483.20.40.40
Noun	Bearing
Keyword String	Flanged
Manufacturer URL	http://www.ina.com
Manufacturer Item Number	PCSLT20
Weight / LBS	0.485
Nominal Bolt Circle Diameter Round	2.8 Inch 71 Millimeter
Bolt Spacing	2.811 Inch 71.4 Millimeter
Length Thru Bore	0.969 Inch 24.6 Millimeter
Bore	0.787 Inch 20 Millimeter
Cartridge Pilot Depth	0 Inch 0 Millimeter
Cartridge Pilot Diameter	0 Inch 0 Millimeter