

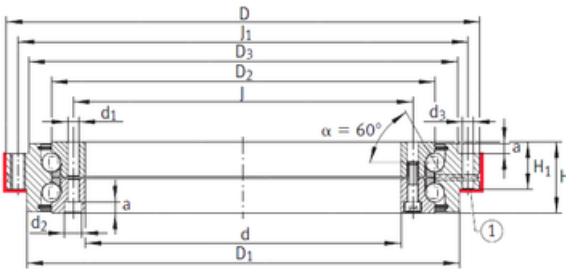

Timken BEARINGS INDUSTRY

INA ZKLDF260 angular contact ball bearings

Bearing No. ZKLDF260



ZKLDF260 Bearing 2D drawings and 3D CAD models

Size	260x385x55 mm
Bore Diameter	260 mm
Outer Diameter	385 mm
Width	55 mm
d	260 mm
D	385 mm
H	55 mm
a	8,2 mm
d1	9,3 mm
d2	15 mm
d3	9,3 mm
D1	345 mm
D2	313 mm
D3	348 mm
H1	36,5 mm
J	280 mm
J1	365 mm
Weight	22 Kg
Dynamic load rating axial (C)	162 kN
Static load rating axial (C0)	920 kN
Category	Bearings
Inventory	0.0
Manufacturer Name	SCHAEFFLER GROUP
Minimum Buy Quantity	N/A
Weight / Kilogram	26.345
Product Group	B00234



Timken BEARINGS INDUSTRY